

Features

- Dual levers allow for a precise control of both volume and temperature settings.
- 1.5 GPM (5.7 LPM) maximum flow rate at 60 psi (4.14 bar).
- 5 1/4" (133mm) spout length.
- HAHN ceramic disc valves provide performance that is enduring for a lifetime and outlasts industry standards.
- Includes pop-up drain.
- Limited Warranty. Details available on website.

Materials

- Premium stainless steel construction for durability and reliability.
- HAHN finishes resist tarnishing and corrosion.

Installation



- Deck-mounted 8" (203mm) installation.
- Minimum of Ø1 3/8" (35mm) diameter holes.

Available Colours/Finishes

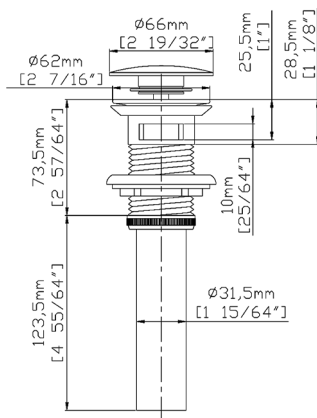
Color	Code	Description
	CR	Polished Chrome
	BN	Brushed Nickel
	MB	Matte Black
	BB	Brushed Brass



Codes & Standards

- Canadian Uniform Plumbing Code™ (cUPC) 
- Lead Free Compliant (AB1953)
- American National Standard (NSF/ANSI 61) 
- ADA (Americans with Disabilities Act) 